

# How to Install Roller Blinds

## Tools you will need:

- Power Drill
- Drill Bit
- Philips Screwdriver Bit
- Pencil
- Spirit Level (if required)

## Supplied materials:

- Roller Blind
- Brackets
- Screws
- Chain stoppers
- Chain Tensioner
- Extra Chain Connectors

## Installation Procedure

Before installation always inspect product for any damages that may have occurred during shipping. Please contact us immediately if any damages are found

*Tips: Do not throw your packaging away in case you need to return your blinds.*

*Tips: Wipe down window to remove any dust and dirt before starting*



1. Place blinds on floor with its indicated roll direction aligned with the window frame
  - a. Front roll, direction of the blinds is away from the window
  - b. Back roll, direction of the blinds is towards the window

Please follow steps according to the correct mounting of your blinds.  
**(See Figure A for reference).**

*Tips: Do not unroll the blinds and keep the clear plastic wrapped onto it. This will keep the alignment of the blinds into place, only take it off once installed onto the brackets.*

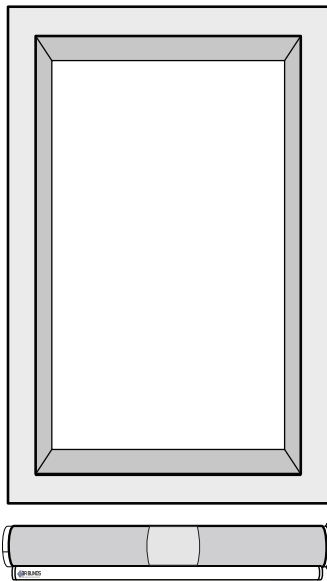

Figure A

2. Indicate the position of your drill holes using the brackets as templates to mark with a pencil:

- a. Recess installation (i.e. inside mount) mark inside the window frame **(See Figure A for reference)**
- b. Facefit installation (i.e. outside mount) place your brackets on each end of the roller and raise the brackets up to the top of the window frame **(See Figure B for reference)**

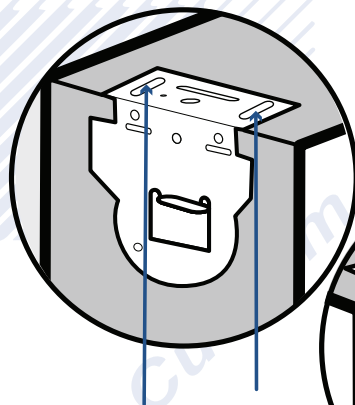
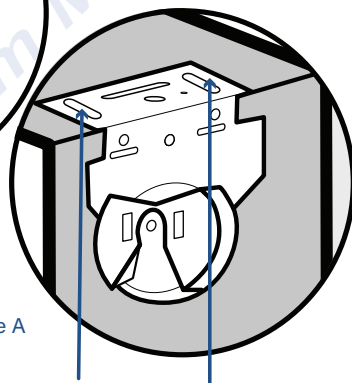

Figure A



Recess mount

Or

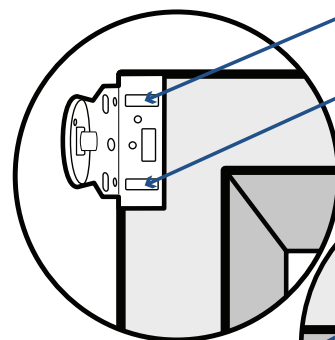
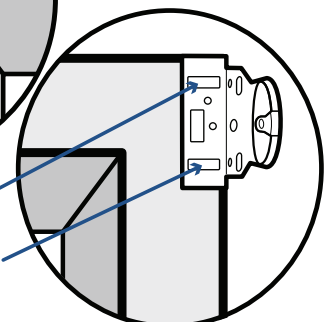

Figure B

Facefit mount



*Tips: Make sure the brackets are at an equal height and that the blind is level (Use spirit level if needed), to ensure that the blind will roll straight up and down.*

**3.** Using the male bracket, secure into the indicated drill position using 2x screws and repeat with female bracket.  
(See Figure A and Figure B for reference).

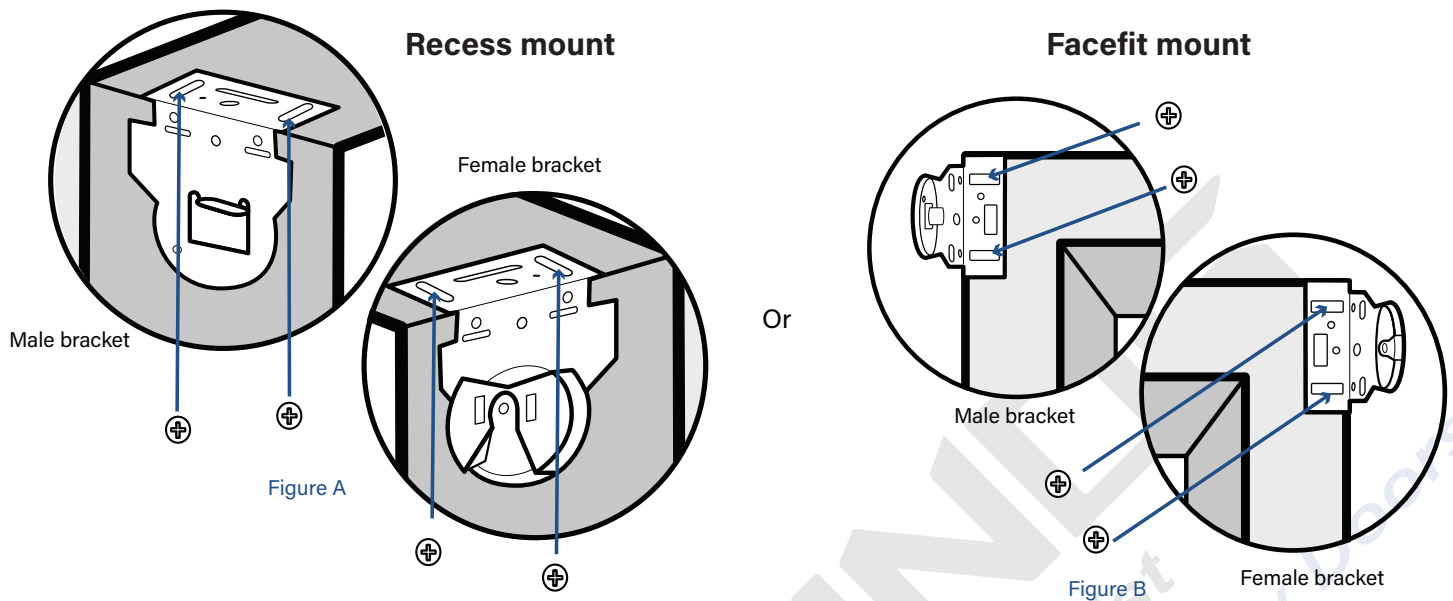

*Tips: Ensure that the male bracket is placed on the side that has been ordered as "control side" ( where the chain hangs).*

**4.** To secure the blinds into place, insert the chain control side first into the bracket. Guide the spring load pin end into the slot of it's bracket pushing until the spring clicks into place.  
(See Figure A and Figure B for reference)

*Tips: Ensure that the top part of the side winder is placed always at the top for a straight alignment.*

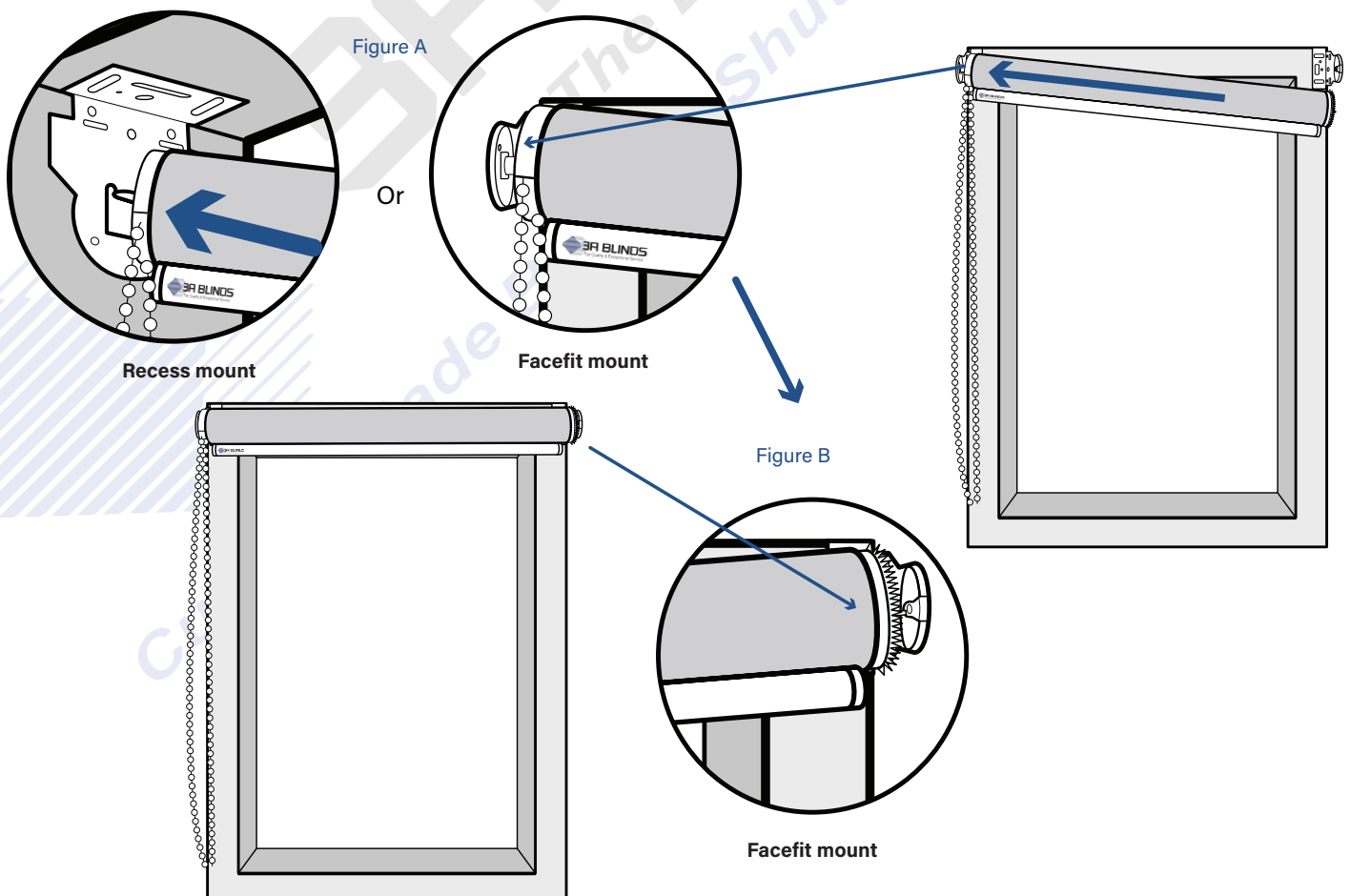

**5.** Once the blind has been secured to the window frame via the brackets, pull the chain to lower the blind to your specified drop and insert chain stopper ( clear round ball) on to the chain.

**a.** For front roll, place it right behind the chain window **(See Figure A for reference)**

**b.** For back roll, place it right in front of the chain window **(See Figure B for reference)**

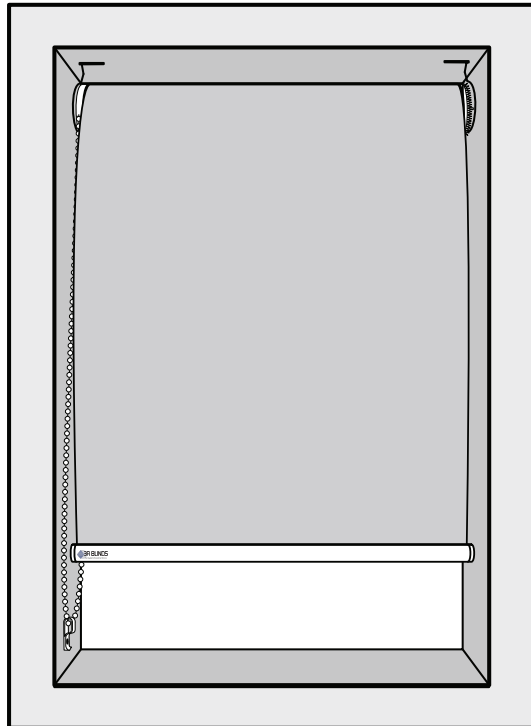

Figure A

Front Roll

Or

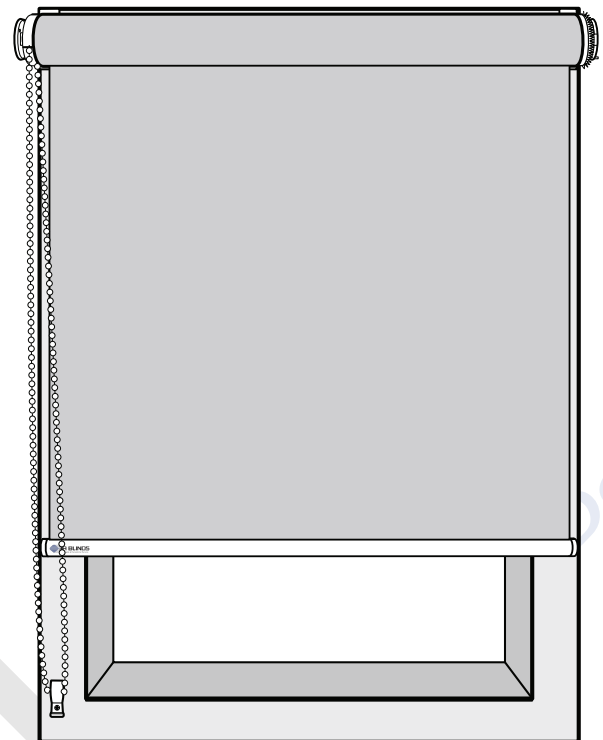

Figure B

Back Roll

*Tips: The ball stopper ensures that fabric won't fall off the roll when pulling the chain down*

**6.** Place chain tensioner on the side of the window frame.

Test the operation of the blind by rolling up and down , before screwing into place.

Once the desired chain tension has been determined screw the chain into place.

**Recess mount**

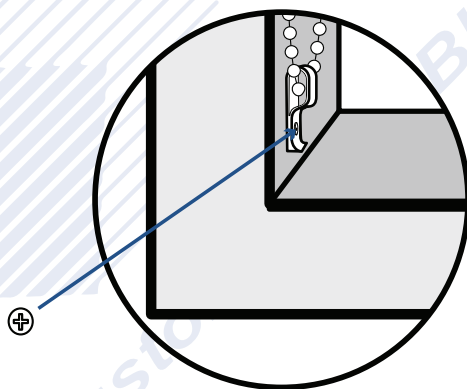

**Facefit mount**

Or

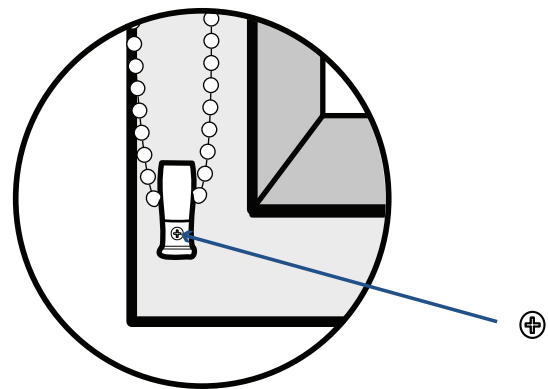

*Tips: If there is too much tension on the chain this can cause poor operation of your blinds , resulting to chain breakage. While loose tension can make your blinds roll down when pulled up.*

**Disclaimer:** Use of chain tensioner is strongly recommended for Child Safety to reduce the hazard of strangulation by the chain.

## Operation

To operate your blind, simply pull on the chain to raise and lower your blind.

To remove your blind, rotate the grooved wheel at the pin end (female side) until the spring loaded pin is fully retracted.

Then, simply slide your blind down or out of the female bracket. The male side will then slide off the male bracket easily.

## Product Care

- Never pull the blind down by hand. Always use the chain, pulling vertically; never on an angle.
- Fabric should be regularly dusted with a soft cloth or feather duster.
- Textured fabric should be regularly vacuumed.
- Wipe fabric clean with a damp cloth and warm, mild soapy water, then leave blind down to dry.
- Soap and/or commercial cleaners must first be tested and allowed to dry in an inconspicuous area to ensure compatibility.
- Do not dry clean, steam clean or iron your blind.
- Avoid excess rubbing and harsh chemicals.
- Avoid exposure to wind or rain.

## Recommendation

Our Roller Blinds comes with the option of having either a PVC or Bonded Pelmet.

Check out our [How to install Pelmet's](#) for more information.

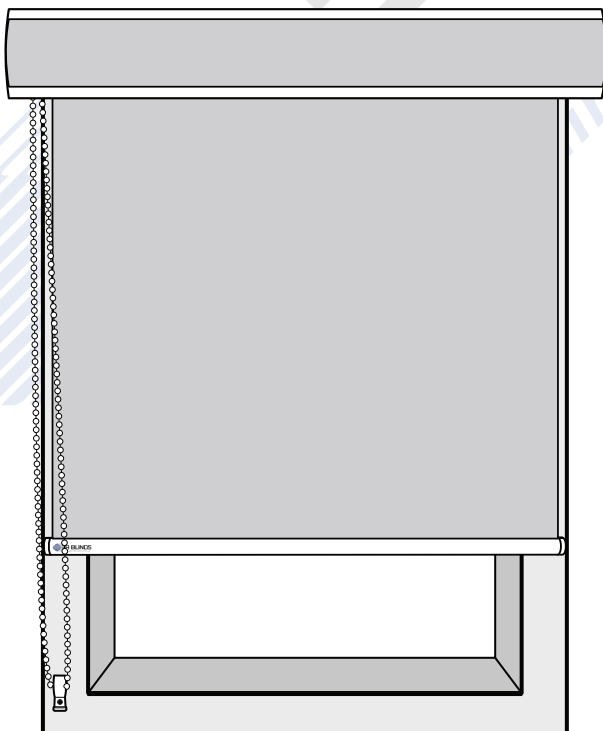

PVC Pelmet

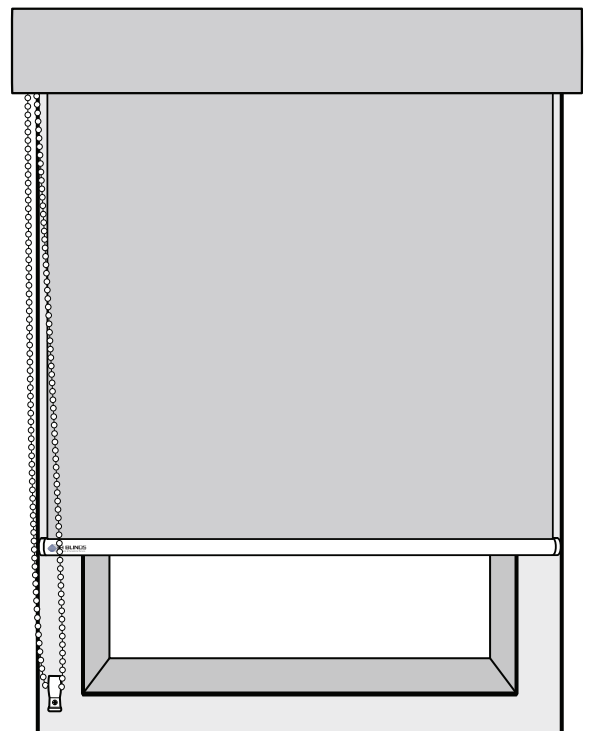

Bonded Pelmet